

| 插针数 Contacts | 料号 Order No. | 产品代号 Part Code | 电缆直径(D) Cable outlet | 重量 Weight |
|-----------------|-----------------|-------------------|-------------------------|--------------|
| 3 | 1630034213001 | M12-F03A-T-D6 | 4-6mm | 27.9g |
| | 1630034213002 | M12-F03A-T-D8 | 6-8mm | 27.7g |
| 4 | 1630044213001 | M12-F04A-T-D6 | 4-6mm | 28.6g |
| | 1630044213002 | M12-F04A-T-D8 | 6-8mm | 28.4g |
| 5 | 1630054213001 | M12-F05A-T-D6 | 4-6mm | 30.4g |
| | 1630054213002 | M12-F05A-T-D8 | 6-8mm | 30.2g |

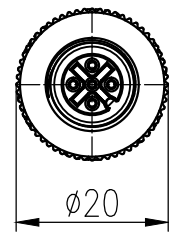
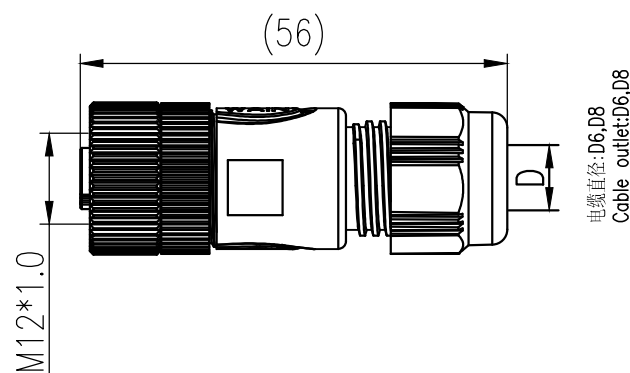

技术参数:

- 产品系列: M12-A 编码
- 插针数: 3 4 5
- 额定电流(40°C): 4A 4A 4A
- 额定电压: 250V 250V 125V
- 额定脉冲电压: 2500V 2500V 1500V
- 污染等级: 3
- 接触电阻: ≤10mΩ
- 防护等级: IP67
- 插拔次数: >100
- 温度范围: -40°C...+85°C
- 绝缘阻抗: ≥100MΩ
- 接线方式: 螺钉锁紧
- 线径范围: max.0.75mm² (max.AWG18)
- 锁紧扭矩: 0.2Nm (螺钉接线)
- 电缆直径: 4-6mm, 6-8mm
- 电缆剥线长度: 20mm
- 导线剥线长度: 5mm

Technical specification:

- Series: M12 A-Code
- Number of contacts: 3 4 5
- Rated current(40°C): 4A 4A 4A
- Rated voltage: 250V 250V 125V
- Rated impulse voltage: 2500V 2500V 1500V
- Pollution degree: 3
- Contact resistance: ≤10mΩ
- Degree of protectio: IP67
- Mating cycles: >100
- Temperature range: -40°C - +85°C
- Insulation resistance: ≥100MΩ
- Termination method: screw connection
- Wire gauge: max.0.75mm² (max.AWG18)
- Torque: 0.2Nm (screw terminal blocks)
- Cable Outlet: 4~6mm, 6-8mm
- Stripping length of the sheath: 20mm
- Stripping length of the individual wire: 5mm

材料特性:

- 锁紧螺帽: 金属
- 插针材料: 铜合金
- 插针表面处理: 镀金
- 外壳材料: PA
- 颜色: RAL 9005 (黑色)
- 绝缘材料: PA

Material properties:

- Material of locking system: Metal
- Material of contact: copper alloy
- Contact plating: Au
- Material of housing: PA
- Colour of housing: RAL 9005 (Black)
- Material of Insert: PA

针位排布图
Contact arrangement

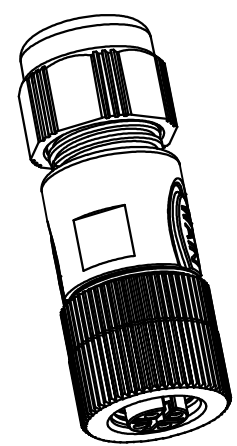
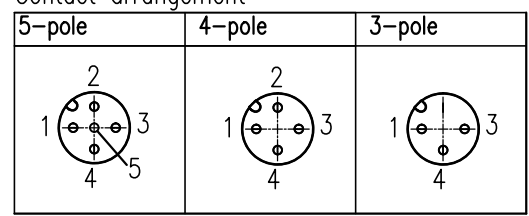

符合标准: IEC 61076-2-101 Standards: IEC 61076-2-101

| 标记 Mark | 处数 Number | 变更描述/Description | | 签名 Signature | 日期 Date | 表面处理 Finish | - | | | | 图号 Drawing No. | - | |
|---------------|--------------|------------------|----------------|-----------------|------------|----------------|------------|---|------------|---|---|---------------|--|
| | | | | | | 材料 Material | - | | | | 产品代号 Part Code | M12-F0xA-T-Dx | |
| | | | | | | 比例 Scale | 版本 REV. | 重量 Weight | 数量 Qty. | - | | | |
| 绘图 Drawn | ZM LIN | 17.09.2014 | 标准化 Stand. | - | - | 1:1 | V1.0 | - | - | - | | | |
| 审核 Checked | YY LUO | 17.09.2014 | | | | | | | | - | | | |
| 工艺 Process | - | - | 批准 Approved | YY LUO | 17.09.2014 | | | All Dimensions in mm Original Size DIN A 4 | | | 厦门唯恩电气有限公司 XIAMEN WAIN ELECTRICAL CO.LTD | | |